

# Hopper

## FARMING

**Hopper** are dispensing hopper which are used for the storage and dispensing of small amounts of dry minerals, pre-mixes and other feed additives. The hopper are available as Type T100 and T160. The discharge from the hopper is made either via a 75 helix or a 100 tube auger. Above all mineral mixtures with a high fat content can be better conveyed with a tube auger. The angle of the tube auger can be set variably from 0° to 60°. With a spiral a capacity of 1.1 t/h is achieved, with a tube auger, depending upon the pitch, between 3.9 and 7.3 t/h. A safety grid is included in the scope of supply.

**Hopper with agitators** are especially well suited for light, slow flowing and difficult to discharge bulk materials such as fish meal etc., due the floor mounted agitator which pushes the bulk material into the screw chutes.

### All advantages at a glance

- ✓ Due to the two vertical sides and an open screw conveyor throughout the entire length of the dispensing hopper, the risk of blockages is very low
- ✓ Available galvanized or in stainless steel depending upon the aggressiveness of the material
- ✓ Additional equipment: Cover, grate for Big Bags, extension for T100 and T160



# Hopper

## FARMING

### Technical Data

Type	Dimensions, mm	Volume, m <sup>3</sup>
Hopper T100	1000 x 1000	0.5
Hopper T160	1600 x 1600	0.65
Hopper with agitator	1000 x 1000	0.45

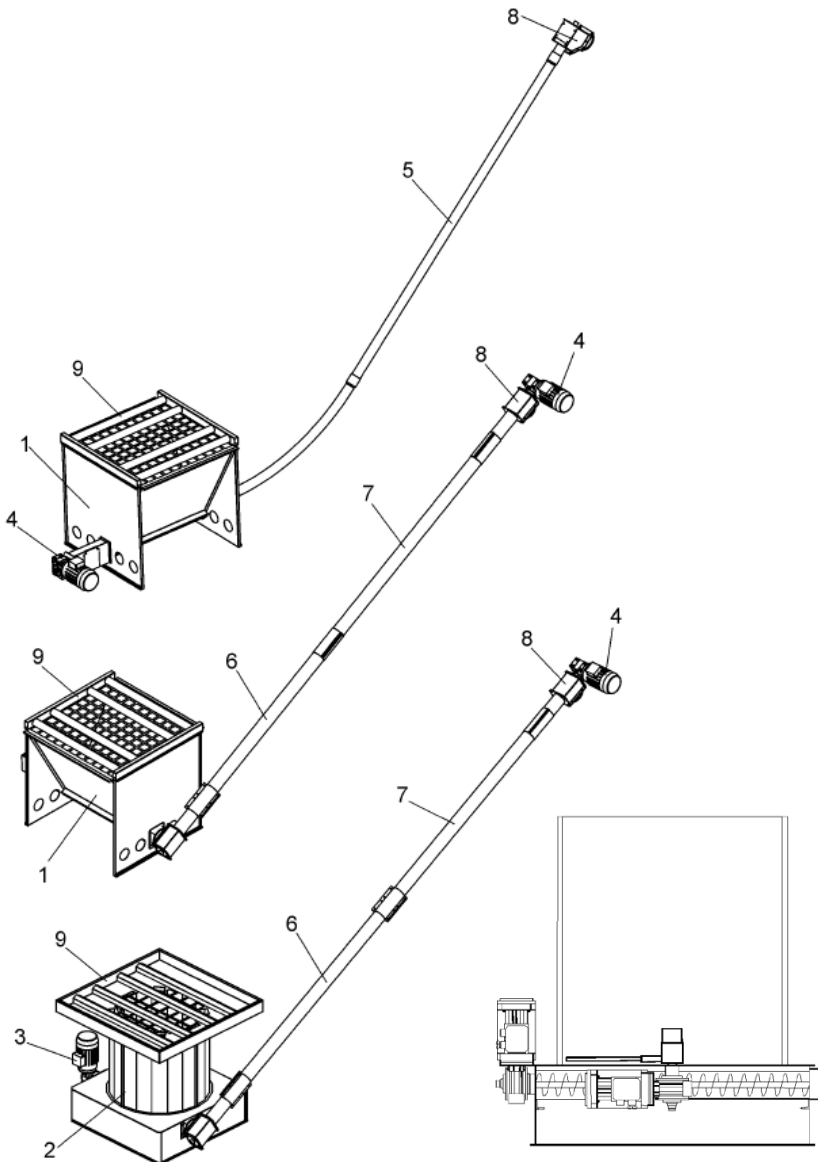

Item	Description
1	Hopper T100
2	Hopper with agitator
3	Gear motor for the discharge screw
4	Gear motor for screw or spiral
5	Spiral 75 mm
6	Screw conveyor 100
7	Conveyor extension
8	Outlet
9	Grate for Big Bags

